

# THREE BOLT FLANGE UNITS

## SBFCT DUCTILE IRON LIGHT DUTY SET SCREW TYPE SAFCT DUCTILE IRON LIGHT DUTY ECCENTRIC LOCKING COLLAR TYPE

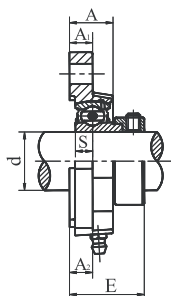
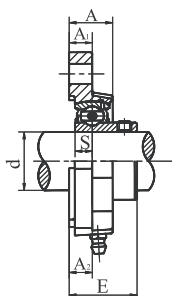
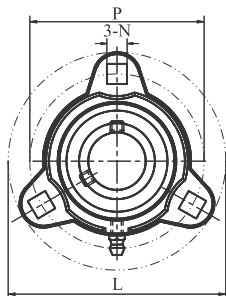

**SBFCT**  
SET SCREW TYPE

**SAFCT**  
ECCENTRIC LOCKING  
COLLAR TYPE

- Ductile iron housing
- Narrow inner ring bearing

FLANGES

Unit No.	Shaft Dia. d		Dimension (in) (mm)								Bolt Size	Bearing No.	Housing No.	Weight (lb)
	(in.)	(mm)	L	P	A <sub>1</sub>	A	A <sub>2</sub>	N	S	E				
<b>SBFCT201G</b>		12												
201-8G	1/2	15	3-3/16	2-1/2	13/32	3/4	13/32	9/32	1/4	1-1/32	1/4	SB201G 201-8G 202G 202-10G 203G 203-11G	FCT203	0.46
202G	5/8	17	81	63.5	10.7	19.1	10.7	7.1	6	26.7				
202-10G														
203G														
203-11G	11/16													
<b>SBFCT204-12G</b>	3/4	20	3-9/16	2-13/16	7/16	25/32	7/16	11/32	9/32	1-5/32	5/16	SB204-12G 204G	FCT204	0.71
204G			90.5	71.4	11.1	19.8	11.1	8.7	7	29.1				
<b>SBFCT205-14G</b>	7/8	25	3-3/4	3	13/32	25/32	13/32	11/32	9/32	1-3/16	5/16	SB205-14G 205-15G 205G 205-16G	FCT205	0.79
205-15G	15/16		95.2	76.2	10.3	19.8	10.3	8.7	7.5	29.8				
205G														
205-16G	1													
<b>SBFCT206-18G</b>	1-1/8	30	4-7/16	3-9/16	15/32	7/8	15/32	13/32	5/16	1-11/32	3/8	SB206-18G 206G 206-19G 206-20G	FCT206	0.82
206G			113	90.5	12	22	12	10.3	8	34				
206-19G	1-3/16													
206-20G	1-1/4													
<b>SBFCT207-20G</b>	1-1/4	35	4-13/16	3-15/16	1/2	15/16	1/2	13/32	11/32	1-7/16	3/8	SB207-20G 207-21G 207-22G 207G 207-23G	FCT207	1.57
207-21G	1-5/16		122.5	100	12.7	23.8	12.7	10.3	8.5	36.2				
207-22G	1-3/8													
207G														
207-23G	1-7/16													

Unit No.	Shaft Dia. d		Dimension (in) (mm)								Bolt Size	Bearing No.	Housing No.	Weight (lb)
	(in.)	(mm)	L	P	A <sub>1</sub>	A	A <sub>2</sub>	N	S	E				
<b>SAFCT201G</b>		12												
201-8G	1/2	15	3-3/16	2-1/2	13/32	3/4	13/32	9/32	1/4	9/32	1/4	SA201G 201-8G 202G 202-10G 203G 203-11G	FCT203	0.57
202G	5/8	17	81	63.5	10.7	19.1	10.7	7.1	6.5	32.8				
202-10G														
203G														
203-11G	11/16													
<b>SAFCT204-12G</b>	3/4	20	3-9/16	2-13/16	7/16	25/32	7/16	11/32	9/32	11/32	5/16	SA204-12G 204G	FCT204	0.75
204G			90.5	71.4	11.1	19.8	11.1	8.7	7.5	34.5				
<b>SAFCT205-14G</b>	7/8	25	3-3/4	3	13/32	25/32	13/32	11/32	9/32	5/16	5/16	SA205-14G 205-15G 205G 205-16G	FCT205	0.86
205-15G	15/16		95.2	76.2	10.3	19.8	10.3	8.7	7.5	33.7				
205G														
205-16G	1													
<b>SAFCT206-18G</b>	1-1/8	30	4-7/16	3-9/16	15/32	7/8	15/32	13/32	11/32	1-1/2	3/8	SA206-18G 206G 206-19G 206-20G	FCT206	1.34
206G			113	90.5	12	22	12	10.3	9	38.7				
206-19G	1-3/16													
206-20G	1-1/4													
<b>SAFCT207-20G</b>	1-1/4	35	4-13/16	3-15/16	1/2	15/16	1/2	13/32	3/8	1-21/32	3/8	SA207-20G 207-21G 207-22G 207G 207-23G	FCT207	1.81
207-21G	1-5/16		122.5	100	12.7	23.8	12.7	10.3	9.5	42.1				
207-22G	1-3/8													
207G														
207-23G	1-7/16													

\* Full cover metal shroud seal standard. Full contact rubber seal (2RS suffix) optional.  
Non-relubricatable units also available (remove G suffix). Contact factory.

